



# PHENYLADE® 60

A phenylalanine-free, powdered medical food containing a balanced mix of essential and non-essential amino acids, carbohydrates, vitamins, minerals and trace elements.

**Indication:** Phenylketonuria  
Suitable for individuals over 1 years of age.

## Nutrition Information

Nutrients	Per 100 g of powder	Per 16.7 g Powder (1 pouch or scoop)
<b>Calories</b>	<b>297</b>	<b>50</b>
<b>Protein Equivalent, g</b>	<b>60.0</b>	<b>10.0</b>
<b>Fat, g</b>	<b>0.88</b>	<b>0.15</b>
Saturated, g	0.23	0.04
Trans, g	0	0
Carbohydrate, g	12.3	2.1
<b>Amino Acids, g</b>		
L-Alanine	5.56	0.93
L-Arginine	4.72	0.79
L-Asparagine	8.36	1.39
L-Cystine	0.81	0.13
L-Glutamine	9.31	1.55
Glycine	3.63	0.61
L-Histidine	1.51	0.25
L-Isoleucine	2.49	0.42
L-Leucine	5.37	0.90
L-Lysine	4.36	0.73
L-Methionine	1.45	0.24
L-Phenylalanine	Nil Added	Nil Added
L-Proline	3.63	0.61
L-Serine	5.37	0.90
L-Threonine	2.76	0.46
L-Tryptophan	1.38	0.23
L-Tyrosine	6.45	1.08
L-Valine	4.01	0.67
L-Carnitine	0.09	0.01
Taurine	0.18	0.03

Vitamins	Per 100 g of powder	Per 16.7 g Powder (1 pouch or scoop)
Vitamin A, IU (mcg RE) (25% as beta-carotene)	2331 (874)	389 (146)
Vitamin D <sub>3</sub> , IU (mcg)	520 (13)	87 (2.2)
Vitamin E, IU (mg α-TE)	23 (15.4)	3.8 (2.6)
Vitamin K, mcg	90	15
Thiamine, mg	2.1	0.35
Riboflavin, mg	1.9	0.32
Vitamin B <sub>6</sub> , mg	2.3	0.38
Vitamin B <sub>12</sub> , mcg	4.2	0.7
Niacin, mg	25	4.1
Folic Acid, mcg	700	117
Pantothenic Acid, mg	8.7	1.5
Biotin, mcg	53	8.8
Vitamin C, mg	113	19
Choline, mg	425	71
Inositol, mg	129	22
<b>Minerals</b>		
Calcium, mg	1300	217
Phosphorus, mg	1194	199
Magnesium, mg	310	52
Iron, mg	18	3
Zinc, mg	12	2
Manganese, mg	2.7	0.45
Copper, mcg	1300	217
Iodine, mcg	180	30
Molybdenum, mcg	60	10
Chromium, mcg	40	6.7
Selenium, mcg	83	14
Sodium, mg	600	100
Potassium, mg	1162	194
Chloride, mg	900	150

# Ordering/Reimbursement Information for PhenylAde® 60 Drink Mix:

Product Code	Reimbursement Code	HCPCS Code*	Product Packaging	Calories Per Can
119852 - Unflavored Cans	00847-0956-02	B4157 or B4162	4 x 454 g (1 lb)	1348
119853 - Vanilla Cans	00847-0956-22	B4157 or B4162	4 x 454 g (1 lb)	1348
119876 - Unflavored Pouches	00847-0956-04	B4157 or B4162	30 x 16.7 g (0.59 oz)	50
119854 - Vanilla Pouches	00847-0956-04	B4157 or B4162	30 x 16.7 g (0.59 oz)	50

\* S9435 = For individuals who submit their bills to insurance on their own.

## Ingredients:

**Unflavored:** L-Asparagine Monohydrate, L-Glutamine, Sugar, L-Tyrosine, L-Lysine Acetate, L-Alanine, L-Leucine, L-Serine, L-Arginine, L-Valine, Tricalcium Phosphate, Glycine, L-Proline, Corn Syrup Solids, L-Threonine, L-Isoleucine, Magnesium Phosphate, Contains <2% of the Following: Sodium Citrate, L-Histidine, L-Methionine, L-Tryptophan, Dipotassium Phosphate, Potassium Chloride, Choline Bitartrate, Soy Lecithin, L-Cystine, Sodium Chloride, Silicon Dioxide, Taurine, Ascorbic Acid, Inositol, L-Carnitine, Ferric Orthophosphate, Vitamin E Acetate, Zinc Sulfate, Niacinamide, Sucralose, Calcium D-Pantothenate, Vitamin K<sub>1</sub>, Manganese Sulfate, Vitamin A Palmitate, D-Biotin, Vitamin D<sub>3</sub>, Beta-Carotene, Copper Sulfate, Pyridoxine Hydrochloride, Potassium Iodide, Thiamine Mononitrate, Riboflavin, Sodium Selenite, Folic Acid, Vitamin B<sub>12</sub>, Chromium Chloride, Sodium Molybdate.

**Contains: Soy.**

**Vanilla:** L-Asparagine Monohydrate, L-Glutamine, Sugar, L-Tyrosine, L-Lysine Acetate, L-Alanine, L-Leucine, L-Serine, L-Arginine, L-Valine, Tricalcium Phosphate, Glycine, L-Proline, L-Threonine, Natural and Artificial Flavors, L-Isoleucine, Magnesium Phosphate. Contains 2% or Less of the Following: Sodium Citrate, L-Histidine, L-Methionine, L-Tryptophan, Dipotassium Phosphate, Potassium Chloride, Choline Bitartrate, Soy Lecithin, L-Cystine, Sodium Chloride, Taurine, Ascorbic Acid, Inositol, Silicon Dioxide, L-Carnitine, Ferric Orthophosphate, Sucralose, Vitamin E Acetate, Zinc Sulfate, Niacinamide, Calcium D-Pantothenate, Vitamin K<sub>1</sub>, Manganese Sulfate, Vitamin A Palmitate, D-Biotin, Vitamin D<sub>3</sub>, Beta-carotene, Copper Sulfate, Pyridoxine Hydrochloride, Potassium Iodide, Thiamine Mononitrate, Riboflavin, Sodium Selenite, Folic Acid, Vitamin B<sub>12</sub>, Chromium Chloride, Sodium Molybdate.

**Contains: Soy.**

## Mixing Instructions:

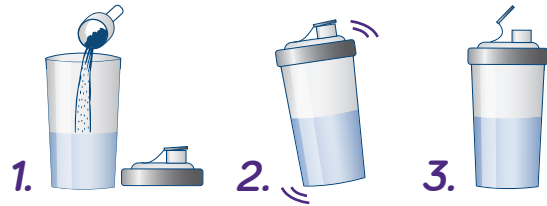

Simply add 1 pouch or scoop (16.7 g) to approx.

3 fl oz (90 mL) of water. Dilution may be adjusted to personal taste. For greater accuracy use a gram scale.

1. Cover with a tight-fitting lid and shake until fully blended.
2. Enjoy immediately or store formula in a refrigerator for no more than 24 hours from time of preparation. Shake or stir prepared stored formula again before use.

**Do not heat, bake or add to food or beverages above 130°F.**

## Storage:

Store unopened cans or pouches in a cool, dry place away from sunlight. Avoid extreme temperatures. Once a pouch is opened, entire contents should be used immediately. Once a can is opened, reseal with lid provided and use within one month.

## Important Notice:

Must only be used under medical supervision. For oral or tube feedings. Not for parenteral use. Not suitable as a sole source of nutrition. Only suitable for individuals over 1 year of age with proven phenylketonuria (PKU).

